

Catalina 25





THE CONCEPT

The Catalina 25 is designed to provide the comfort, performance and style of a large yacht in a practical-sized, trailerable boat.

Her modern full hull shape, with a long water line and horizontal skeg aft, gives you all of the most desired performance characteristics, sure handling and easy motion, together with competition speed and a well balanced helm.

Her low-swept trunk cabin features large, sturdy hatches for good ventilation and plenty of safety glass windows for light and visibility. Yet, keeps the traditional graceful low profile and appearance of the finest classic yachts.

We've used the tremendous volume of her full hull shape to create an interior that's spacious and luxurious. Your family and friends can relax in comfort and in style, whether your outing is a weekend sail or an extended cruise.



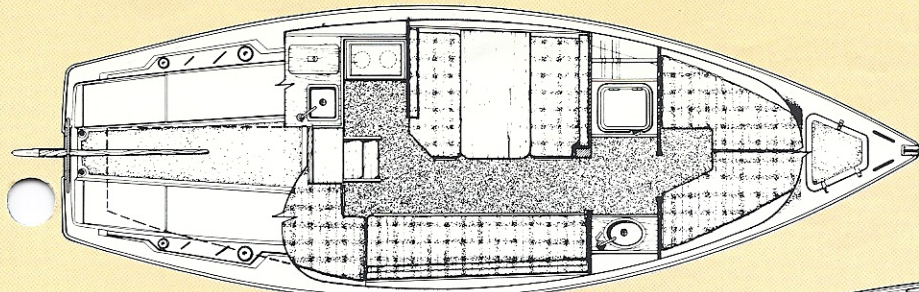

DINETTE INTERIOR

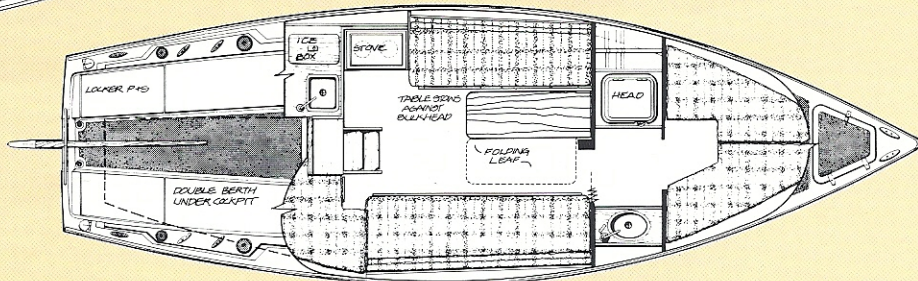

TRADITIONAL INTERIOR

ACCOMMODATIONS

The Catalina 25's self-bailing cockpit is roomy enough for the family, guests, or racing crew. The cockpit seats are generously wide and have comfortable, angled seat backs.

Beneath the port cockpit seat, you'll find a huge locker with ample storage for an outboard, sails, fuel tank, and safety gear.

The interior is spacious. The galley is roomy, efficient and handy to the cockpit. When equipped with a top-loading icebox, a two-burner stove, stainless steel sink and Formica counter tops, it makes meals on board fun and easy to prepare.

You may choose either the dinette interior or the alternate traditional table arrangement. Both provide comfortable seating for the entire crew.

Either interior arrangement is available in the retractable or fixed keel hull.

The unique double aft quarter berth and the forward V-berth area afford the privacy and comfort of two separate cabins for two couples or the cruising family.

You will be pleasantly surprised at how much usable storage space is built in under the seats and berths.

To compliment the Catalina 25's comfortable accommodations, the main cabin is trimmed with solid teakwood for warmth and traditional beauty.

A wide selection of options, upholstery fabrics, vinyls, carpets, and molded in exterior colors invite you to create your own distinctive Catalina 25.



Catalina Yachts



SPECIFICATIONS

L.O.A.	25'0"
L.W.L.	22'2"
Beam	8'0"
Sail Area STD Rig	270 sq. ft.
Sail Area Tall Rig	295 sq. ft.
	RETRACTABLE FIXED KEEL WING KEEL
Draft	2'8" 4'-0" 2'-10"
Board Down	5'0"
Ballast	1500 lbs. 1900 lbs. 1750 lbs.
Displacement	4150 lbs. 4550 lbs. 4400 lbs.

	STANDARD RIG	TALL RIG
P	24' - 8"	27' - 8"
I	29' - 0"	31' - 0"
J	10' - 6"	10' - 6"
E	9' - 7"	9' - 7"

All measurements are approximate

Patent numbers 3805724, 3648310 and 111523

- FLIP-TOP AVAILABLE.
INCREASES HEADROOM TO 6'6"
- SELF-BAILING COCKPIT
- ADJUSTABLE TRAVELER WITH CONTROLS, STANDARD
- MOLDED IN SHEER STRIPE AND WATERLINE COLORS STD.
- FIBERGLASS RUDDER WITH LAMINATED HARDWOOD TILLER STANDARD
- SOLID TEAK TRIM

- HAND LAY UP DECK WITH DECK LINER
- HAND LAY UP HULL WITH HULL LINER
- ANCHOR LOCKER WITH DRAIN ON FOREDECK STANDARD
- NON-SKID PATTERN MOLDED ON DECK AREAS
- TWO COCKPIT HATCHES WITH SAIL LOCKER
- FLUSH FITTING FORWARD HATCH STANDARD
- STORM COVER FOR MAIN HATCH STANDARD
- STAINLESS STEEL CHAIN PLATES AND STANDING RIGGING

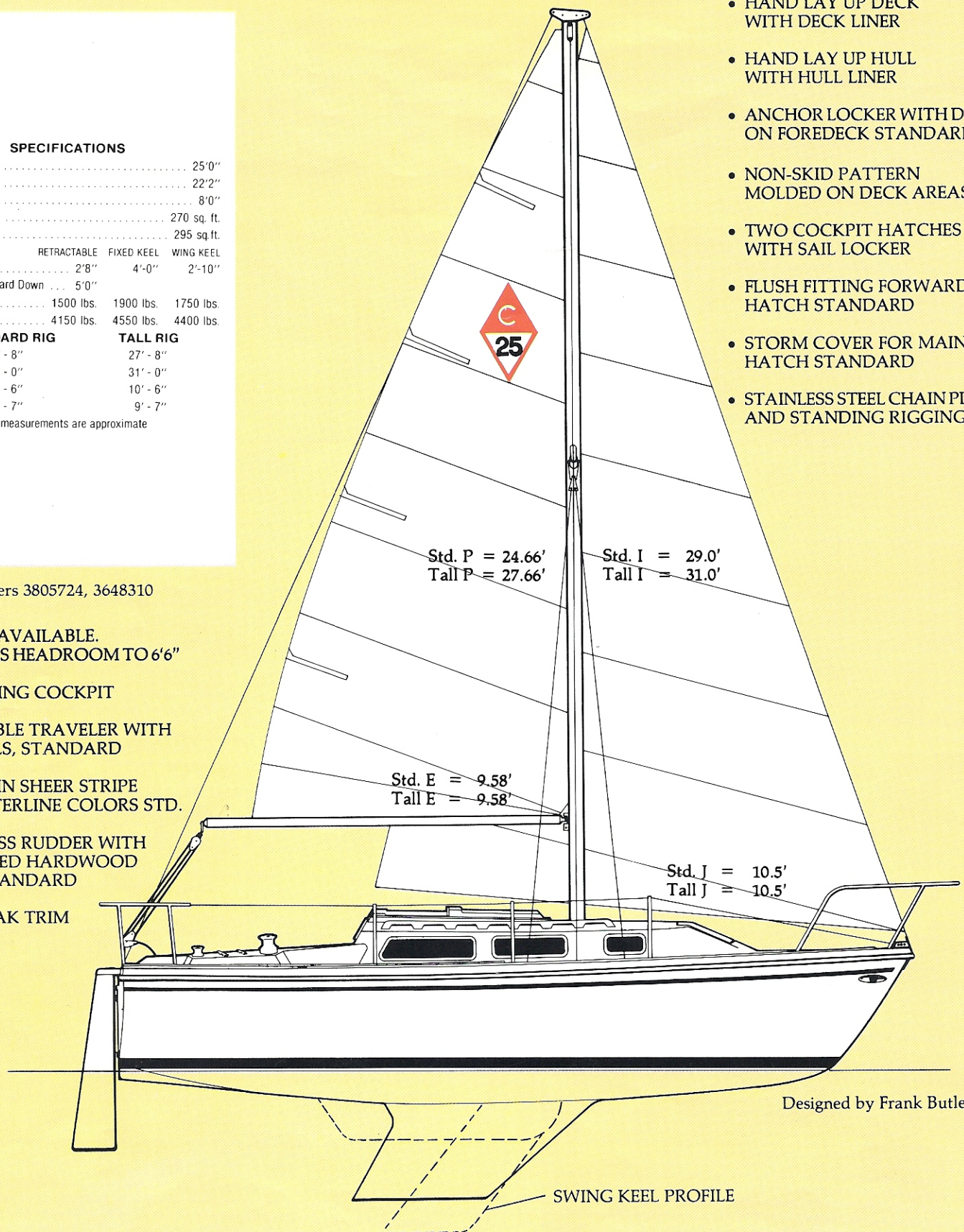

Designed by Frank Butler

SWING KEEL PROFILE

Catalina Yachts

21200 Victory Boulevard • Woodland Hills, California 91367

Demonstrated and sold by

Catalina 25

BY **Catalina** Yachts

12/20/87

Custom Order Your Catalina

SUGGESTED PRICE LIST & ORDER FORM

Extended 5 year Gel Coat Limited Warranty*

- One Piece Fiberglass Hull, White
- One Piece Fiberglass Deck, White
- Molded in Waterline and Sheer Stripe
- Complete Hull Liner
- Cabin Deck Liner
- White Deck With Molded in Non-Skid Surfaces
- Two Cockpit Seat Locks
- Winch Handle
- Teak Handrails on Cabin Top

- Anodized Mast and Boom
- Opening Ports (2)
- Stainless Steel Standing Rigging
- Stainless Steel Mast Step
- Genoa Tracks with Cars
- Primary Winches (2) in Cockpit
- Electrical System with Cabin and Navigation Lights, 12 Volt Panel and Deep Cycle Battery

- Steaming Light on Mast
- Main Cabin Vinyl Door
- Bow and Stern Pulpits with Stanchions and Lifelines
- Aft Galley with Ice Box, Sink, and Storage Drawers
- Fresh Water System with Deck Fill and Vent
- Laminated Wood Tiller

- Deck Light on Mast
- Anchor Light on Masthead
- Vanity Counter with Basin
- Manual Thru-Deck Mounted Bilge Pump
- Interior Fabric Covered Cushions
- Teak Interior
- Solid Teak Hatch Boards
- 110% Jib with Sheets
- Mainsail with Reefpoints, Slugs on Luff, and Class Insignia
- Mainsail Cover

_____ E 01 01	Aluminum Model	\$14,995.00, F.o.b.
_____ E 02 02	Wing Keel Model	\$14,995.00, F.o.b.

STANDARD EQUIPMENT

YOU HAVE A CHOICE WITH CUSTOM CATALINA OPTIONS

INTERIOR OPTIONS

_____ E 42 01	Cabin Curtains for Fixed Windows	125.00
_____ E 42 05	Forward Cabin Vinyl Door	32.00
_____ E 42 09	Carpeting	85.00
_____ E 44 08	Two Burner Gimballed Alcohol Stove	295.00
_____ E 44 09	Two Burner Stove Gimballed	
_____ E 44 10	Compressed Natural Gas	895.00
_____ E 55 03	Masthead w/Heading Tank and	
_____ E 55 04	Deck Mounted Outlet	245.00
_____ E 60 01	Bolt Contained Head w/Platform	135.00

FITTINGS AND EQUIPMENT

_____ E 11 09	Coated Hull in Lieu of Std. White	125.00
_____ E 11 01	Two Tone Deck in Lieu of Std. Solid White	165.00
_____ E 26 03	Stern Mounted Boarding Ladder	125.00
_____ E 40 01	Covered Stanchions, Vinyl, Specify Color	145.00
_____ E 22 07	Tiller Cover, Blue	15.00
_____ E 40 04	Catalina and Equipment Package	395.00
_____ E 21 01	Genoa Cover on Box	20.00
_____ E 40 10	Stainless Steel	450.00
_____ E 40 01	Anchor Light, Bronze Bolt	375.00
_____ E 40 01	Pro-Trip Lendray Cushion	160.00
_____ E 40 01	Top Up with Flaring Hatch	385.00
_____ E 27 08	Hood Cover	595.00

WINCHES

_____ E 24 01	2 Speed Jib Sheet Winches (in Lieu of Std.)	185.00
_____ E 24 04	Single Speed Self Tailing Winches	
_____ E 24 01	Self Tailing (Std.)	275.00
_____ E 31 02	1/2 Heavy Duty Winch on Cabin Top, Port	70.00
_____ E 31 02	Main Heavy Duty Winch on Cabin Top, Starboard	70.00

RIGGING OPTIONS

_____ E 33 03	Split Backstay w/Tension Adjuster	95.00
_____ E 35 07	Whisker Pole, Telescoping	135.00
_____ E 35 08	Boom Vang	55.00
_____ E 35 10	Jiffy Reefing on Boom	35.00
_____ E 38 00	Tall Rig	250.00
_____ E 33 02	Head Sail Furling Gear, Less Sails	695.00

SAILS FOR STANDARD RIG

_____ E 37 07	150% Genoa w/Sheets	380.00
_____ E 37 09	150% Genoa for Furling w/Sunscreen & Sheets	480.00
_____ E 37 11	Poleless Cruising Spinnaker with Gear	
	Specify Colors	645.00

SAILS FOR TALL RIG, CUSTOM QUALITY

_____ E 38 06	150% Genoa w/Sheets	410.00
_____ E 38 07	150% Genoa for Furling w/Sheets	520.00
_____ E 38 08	Poleless Cruising Spinnaker with Gear	610.00
	Specify Colors	695.00

ELECTRICAL

_____ E 70 01	110 Volt Dockside Power	125.00
_____ E 71 01	25' Shore Power Cord for E 70 01	95.00
_____ E 73 01	Battery (Extra) and Box	125.00
_____ E 79 01	Knotmeter (w/Log) on Bulkhead	395.00

AUXILIARY POWER

_____ E 50 01	Outboard Bracket, Stainless Steel	130.00
_____ E 51 02	2 Cylinder Inboard F.W. Cooled Universal Model 12, 10 H.P.	
	Diesel Engine	3985.00
	Trailer, Dealer Supplied	
	Freight Charge	
	Commissioning Charge	
	State Tax	

Total _____

*For precise terms of the limited warranty please refer to the Limited Warranty Booklet

SHEER STRIPE AND WATER LINE COLORS: DRAGON RED _____ MIDWATCH BLUE _____ GREY _____ WHITE _____ DRAGON RED & MIDWATCH BLUE _____
 OPTIONAL TWO TONE DECK IN LIEU OF STD. SOLID WHITE, WHITE AND GREY _____ WHITE AND BEIGE _____
 OPTIONAL COLORED HULL IN LIEU OF STD. WHITE, GREY _____ BEIGE _____

Interior Cushions _____ Carpet _____ Cockpit Cushions beige _____ white _____

Dealer _____ Deliver To _____ P.O. No. _____

_____ Deposit \$ _____

_____ Check No. _____

Date _____ By _____ Customer _____ Hull No. _____ OFFICE USE ONLY

NOTE: 1. All prices and specifications are subject to change at any time including after receipt of the customer's order, until final delivery to the customer.
 2. Barrier coat and anti-fouling paint must be applied to bottom if boat is to be stored in the water.

Catalina Yachts

25

SPECIFICATIONS

LOA 25'0"
 LWL 22'2"
 Beam 8'0"
 Sail Area STD Rig 270 sq ft
 Sail Area Tall Rig 295 sq ft

	FIN KEEL	WING KEEL
Draft	4'6"	2'10"
Ballast	1990 lbs	1750 lbs
Displacement	4550 lbs	4400 lbs

STANDARD RIG

P 24'8"
 I 29'0"
 J 10'6"
 E 9'7"

TALL RIG

P 27'8"
 I 31'0"
 J 10'6"
 E 9'7"

All measurements are approximate.

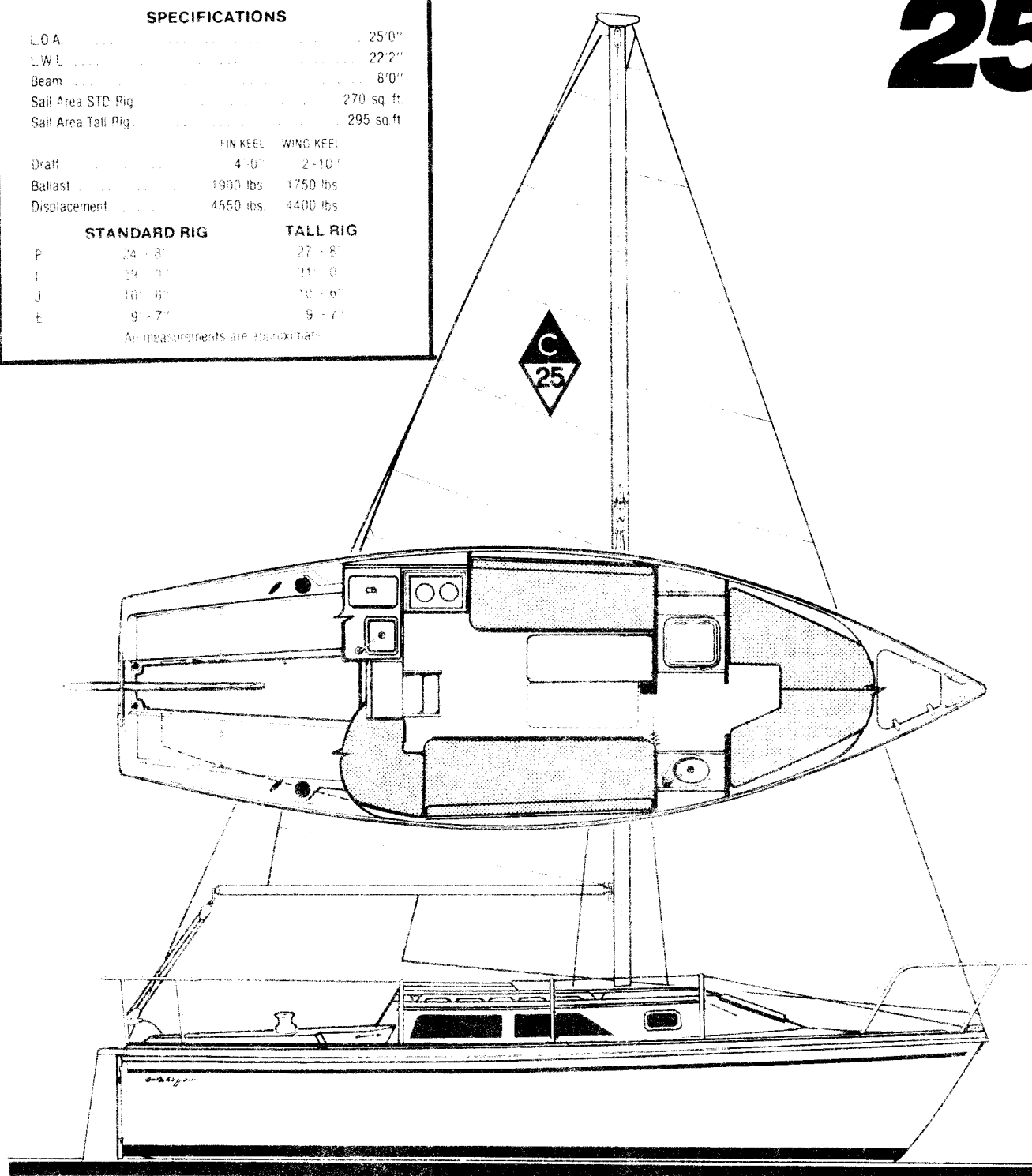

Catalina Yachts

21200 Victory Boulevard • Woodland Hills, California 91367

Catalina 25

BY

Catalina Yachts

1-14-90

Custom Order Your Catalina

SUGGESTED PRICE LIST & ORDER FORM

STANDARD EQUIPMENT

- One Piece Fiberglass Hull, White
- One Piece Fiberglass Deck, White
- Molded in Waterline and Sheer Stripe
- Complete Hull Liner
- Cabin Deck Liner
- White Deck With Molded in Non-Skid Surfaces
- Two Cockpit Seat Lockers
- Winch Handle
- Teak Handrails on Cabin Top
- Anodized Mast and Boom
- Opening Ports (2)
- Stainless Steel Standing Rigging
- Stainless Steel Mast Step
- Genoa Tracks with Cars
- Primary Winches (2) in Cockpit
- Electrical Systems with Cabin and Navigation Lights, D.C. Panel and Deep Cycle Battery
- Pop Top with Sliding Hatch
- Steaming Light on Mast
- Main Cabin Vinyl Door
- Bow and Stern Pulpits with Stanchions and lifelines
- Aft Galley with Ice Box, Sink, and Storage Drawers
- Freshwater system with Deck Fill and Vent
- Laminated Wood Tiller
- Pop Top Enclosure Curtain with Screens
- Main Halyard Winch
- Deck Light on Mast
- Anchor Light on Masthead
- Vanity Counter with Basin
- Manual Thru-Deck Mounted Bilge Pump
- Interior Fabric Covered Cushions
- Teak Interior
- Solid Teak Hatch Boards
- 110% Jib with Sheets
- Mainsail with Reefpoints, Slugs on Luff, and Class insignia
- Jib Halyards Winch
- Extended 5 year Gel Coat Limited Warranty*

___ EI 0251 Fin Keel Model with Standard Equipment and Sails \$17,995. F.O.B.

YOU HAVE A CHOICE WITH CUSTOM CATALINA OPTIONS

INTERIOR OPTIONS

- ___ EI 4201 Cabin Curtains for Fixed Windows \$135.
___ EI 4205 Forward Cabin Vinyl Door 32.
___ EI 4209 Carpeting 90.
___ EI 4408 Two Burner Gimballed Alcohol Stove 375.
___ EI 6503 Marine Head w/Holding Tank and Deck Discharge Outlet 245.
___ EI 6802 Self-Contained Head w/Platform 135.

FITTINGS AND EQUIPMENT

- ___ EI 0222 Wing Keel, in Lieu of Std. 495.
___ EI 1501 Two Tone Deck in Lieu of Std. Solid White 185.
___ EI 2803 Stern Mounted Boarding Ladder 135.
___ EI 4001 Cockpit Cushions, Vinyl Specify Color 160.
___ EI 2707 Tiller Cover Blue 20.
___ EI 2709 Mainsail Cover, Blue 100.
___ EI 2207 Trailer Eye, on Bow 45.
___ EI 9910 Shipping and Storage Cradle, Steel 450.
___ EI 1601 Anti-Fouling Bottom Paint 450.
___ EI 9909 Safety and Equipment Package 395.

WINCHES

- ___ EI 2404 Single Speed Self Tailing Winches (in Lieu of Std.) 275.

RIGGING OPTIONS

- ___ EI 3303 Split Backstay w/Tension Adjuster \$125.
___ EI 3507 Whisker Pole 135.
___ EI 3508 Boom Vang 85.
___ EI 3510 Jiffy Reefing on Boom 45.
___ EI 3801 Tall Rig Mast, in Lieu of Std. \$395.
___ EI 3301 Head Sail Furling Gear, Cruising Design, Less Sails 595.

- ___ EI 3110 Painted Mast and Boom, White 395.

SAILS FOR STANDARD RIG

- ___ EI 3703 Radial Furling Jib w/U.V. Panels in Place of Std. Jib 75.
___ EI 3707 150% Genoa w/Sheets 595.
___ EI 3709 150% Radial Furling Genoa w/U.V. Panels & Sheets 675.
___ EI 3711 Poleless Cruising Spinnaker with Gear, Specify Colors, Option A___ B___ 695.

SAILS FOR TALL RIG, CUSTOM QUALITY

- ___ EI 3803 Radial Furling Jib w/U.V. Panels in Place of Std. Jib 85.
___ EI 3806 150% Genoa with Sheets 645.
___ EI 3807 150% Radial Furling Genoa w/U.V. Panels & Sheets 725.
___ EI 3811 Poleless Cruising Spinnaker with Gear, Specify Colors, Option A___ B___ 740.

ELECTRICAL

- ___ EI 7001 D.C. Dockside Power w/Breaker and Panel 125.
___ EI 7101 25' Shore Power Cord for A.C. Power 95.
___ EI 7301 Battery (Second) and Box w/Select Switch 195.
___ EI 7901 Knotmeter (with Log) on Bulkhead 395.

AUXILIARY POWER

- ___ EI 5002 Outboard Bracket, Stainless Steel 165.
___ EI 5102 2 Cylinder Inboard F.W. Cooled Universal Model 2-12, Diesel Engine 4,695.

Trailer, Dealer Supplied
Freight Charge
Commissioning Charge
State Tax

Total

SHEER STRIPE AND WATER LINE COLORS DRAGON RED___ MIDWATCH BLUE___ GREY___ BURGUNDY___

OPTIONAL TWO TONE DECK IN LIEU OF STD. SOLID WHITE___ WHITE AND GREY___ WHITE AND BEIGE___

Interior Cushions___ Carpet___ Cockpit Cushions, white___ beige___

Dealer___ Deliver To___ P.O. No___

Deposit \$___

Check No___

Hull No___

Date___ By___ Customer___

Note: 1. All prices and specifications are subject to change without notice. 2. For price and terms of the limited warranty, please refer to the Limited Warranty Booklet.

OFFICE USE ONLY